



PROJECT

PARK BRIDGE,
OLDHAM

CLIENT

OLDHAM COUNCIL

CONSULTANT

AECOM
1 New York Street
Manchester
M1 4HD
Fax +44 (0)161 601 1799
Tel +44 (0)161 601 1700
www.aecom.com

KEY PLAN

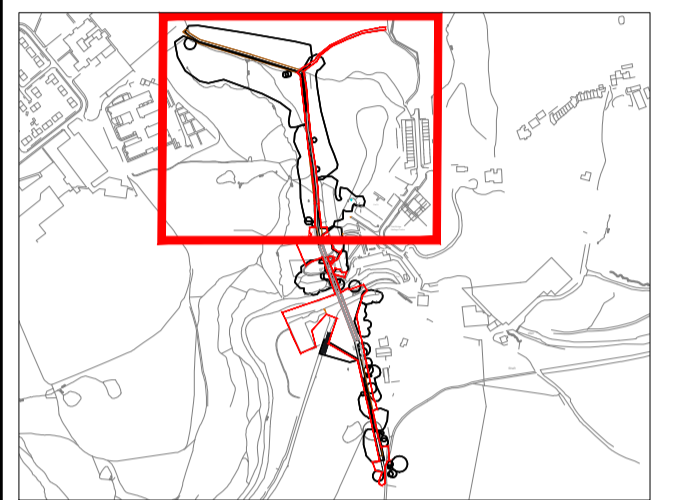

GENERAL NOTES

1. THIS DRAWING IS TO BE READ IN CONJUNCTION WITH ALL OTHER RELEVANT DOCUMENTATION.
2. DO NOT SCALE FROM THIS DRAWING. USE ONLY PRINTED DIMENSIONS.
3. ALL DIMENSIONS ARE IN METRES UNLESS DEFINED OTHERWISE.
4. THIS DRAWING IS TO BE READ IN CONJUNCTION WITH THE PROJECT HEALTH & SAFETY FILE FOR ANY IDENTIFIED POTENTIAL RISKS.
5. ALL PIPE LOCATIONS, DIAMETERS, INVERT LEVELS & COVER LEVELS ARE INDICATIVE ONLY AND WILL BE CONFIRMED AT DETAILED DESIGN.
6. THIS DRAWING IS INDICATIVE ONLY.

KEY

- INDICATIVE SITE BOUNDARY
- EXISTING TREE, GROUP, WOODLAND, OR HEDGE TO BE RETAINED
- EXISTING TREE, GROUP, WOODLAND, OR HEDGE TO BE REMOVED
- PROPOSED TREE
- ▨ TREE CLEARANCE AREA
ORIGINAL AREA DESIGNATED FOR TREE CLEARANCE
- ▨ NEW CYCLE ROUTE SURFACE
- ▨ PROPOSED WOODLAND MIX PLANTING
COMPENSATORY PLANTING
- ▨ WOODLAND SEED MIXTURE

DRAWING STATUS

PLANNING

ISSUE/REVISION

NO	DATE	DESCRIPTION
P04	30/11/22	THIRD ISSUE - UPDATED RLB
P03	15/11/22	SECOND ISSUE
P02	10/06/22	FIRST ISSUE
P01	10/01/22	DRAFT ISSUE
IR/	DATE	DESCRIPTION

PROJECT NUMBER

60653244

SHEET TITLE

LANDSCAPE LAYOUT PLAN

SHEET NUMBER

60653244-ACM-00-01-SE-0001

REV.

P04

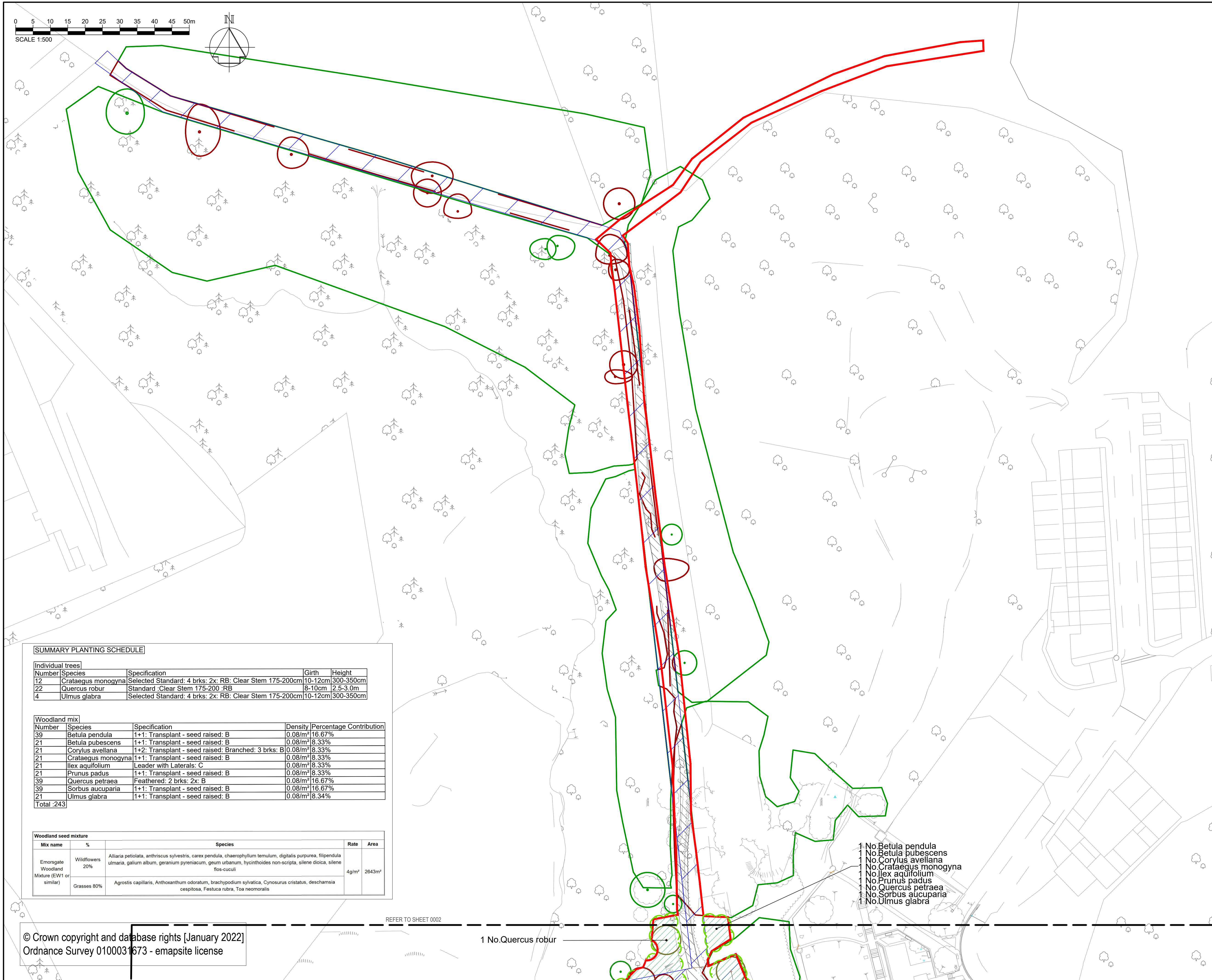

SUMMARY PLANTING SCHEDULE

Number	Species	Specification	Girth	Height
12	Crataegus monogyna	Selected Standard: 4 brks: 2x: RB: Clear Stem 175-200cm	10-12cm	300-350cm
22	Quercus robur	Standard: Clear Stem 175-200 :RB	8-10cm	2.5-3.0m
4	Ulmus glabra	Selected Standard: 4 brks: 2x: RB: Clear Stem 175-200cm	10-12cm	300-350cm

Number	Species	Specification	Density	Percentage Contribution
39	Betula pendula	1+1: Transplant - seed raised: B	0.08/m ²	16.67%
21	Betula pubescens	1+1: Transplant - seed raised: B	0.08/m ²	8.33%
21	Corylus avellana	1+2: Transplant - seed raised: Branched: 3 brks: B	0.08/m ²	8.33%
21	Crataegus monogyna	1+1: Transplant - seed raised: B	0.08/m ²	8.33%
21	Ilex aquifolium	Leader with Laterals: C	0.08/m ²	8.33%
21	Prunus padus	1+1: Transplant - seed raised: B	0.08/m ²	8.33%
39	Quercus petraea	Feathered: 2 brks: 2x: B	0.08/m ²	16.67%
39	Sorbus aucuparia	1+1: Transplant - seed raised: B	0.08/m ²	16.67%
21	Ulmus glabra	1+1: Transplant - seed raised: B	0.08/m ²	8.34%
Total :243				

Mix name	%	Species	Rate	Area
Emorsgate Woodland Mixture (EW1 or similar)	20%	Alliaria petiolata, anthriscus sylvestris, carex pendula, chaerophyllum temulum, digitalis purpurea, filipendula ulmaria, gallium album, geranium pyreniacum, geum urbanum, hycinthoides non-scripta, silene dioica, silene flos-cuculi	4g/m ²	2643m ²
	Grasses 80%	Agrostis capillaris, Anthoxanthum odoratum, brachypodium sylvatica, Cynosurus cristatus, deschamsia cespitosa, Festuca rubra, Toa neomoralis		

- 1 No Betula pendula
- 1 No Betula pubescens
- 1 No Corylus avellana
- 1 No Crataegus monogyna
- 1 No Ilex aquifolium
- 1 No Prunus padus
- 1 No Quercus petraea
- 1 No Sorbus aucuparia
- 1 No Ulmus glabra

This drawing has been prepared for the use of AECOM's client. It may not be used, modified, reproduced or relied upon by third parties, except as agreed by AECOM or as required by law. AECOM accepts no responsibility, and denies any liability whatsoever, to any party that uses or relies on this drawing without AECOM's express written consent. Do not scale this document. All measurements must be obtained from the stated dimensions.